

MODEL	PVA61AMD01	PVA62AMD01	PVA63AMD01	PVA64AMD01	PVA65AMD11	PVA66AMD02	PVA67AMD02	PVA68AMD03
ACTUATOR	AP10DA	AP10DA	AP10DA	AP10DA	AP14DA	AP20DA	AP20DA	AP30DA
SIZE	1/4	3/8	1/2	3/4	1	1 1/4	1 1/2	2
A	2.68	2.68	2.68	3.20	3.46	4.17	4.72	5.39
B	0.45	0.50	0.59	0.79	0.99	1.26	1.50	1.97
C	1.59	1.59	1.59	1.85	2.10	2.21	2.88	3.21
D	5.09	5.09	5.09	5.35	5.60	6.03	6.70	7.58
E	2.61	2.61	2.61	2.61	2.61	2.82	2.82	3.23
F	4.65	4.65	4.65	4.65	4.65	5.26	5.26	5.53
G	3.50	3.50	3.50	3.50	3.50	3.82	3.82	4.37
MAX. Δ PSI	300 CWP	300 CWP	300 CWP	300 CWP	300 CWP	300 CWP	300 CWP	300 CWP
WT. LBS	2.32	2.32	2.32	4.01	4.74	6.40	8.49	13.89

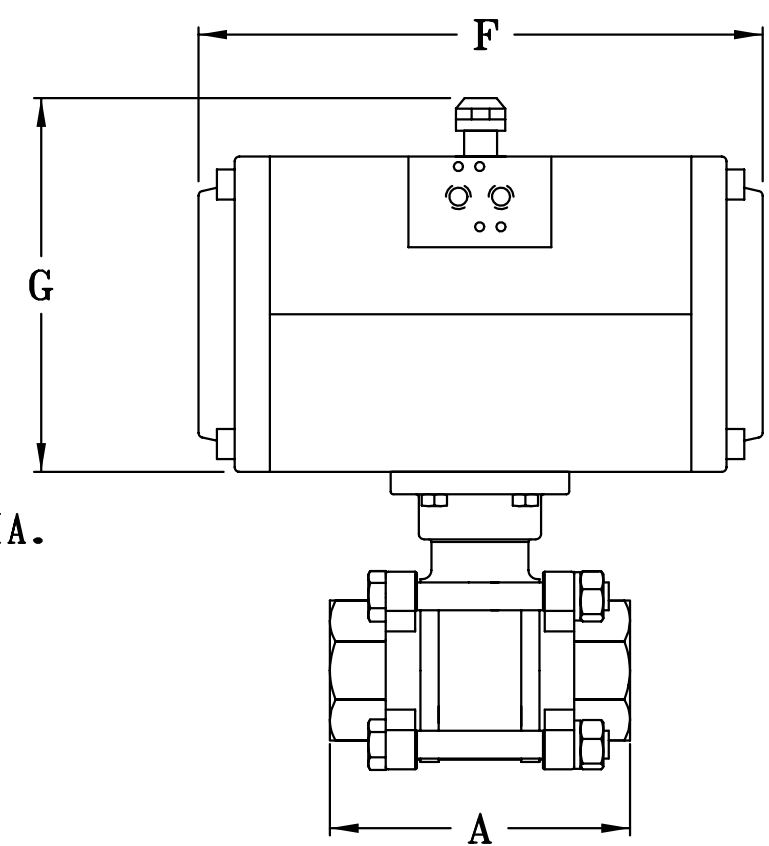
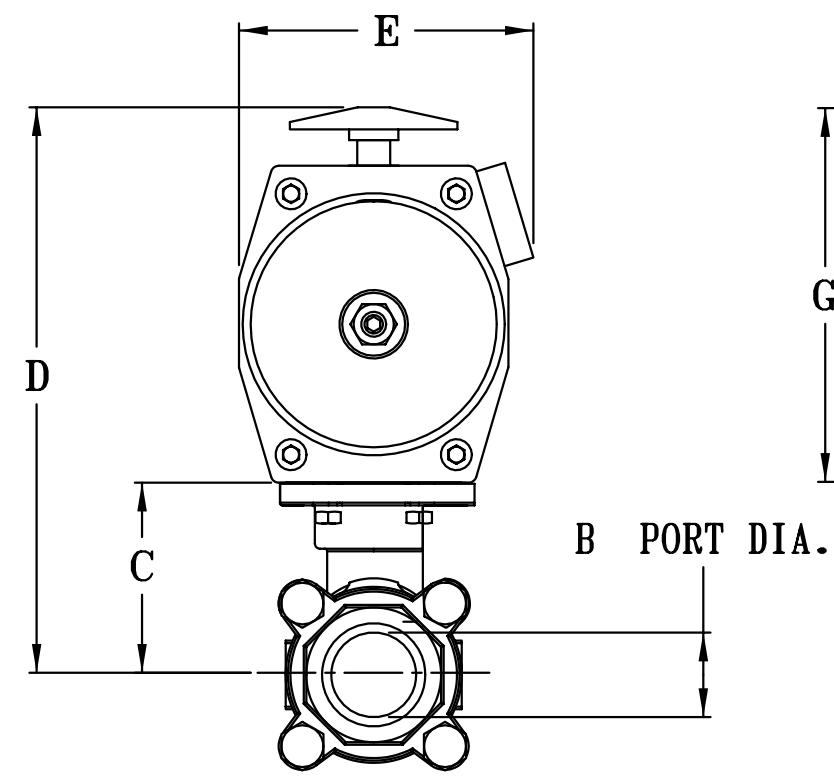
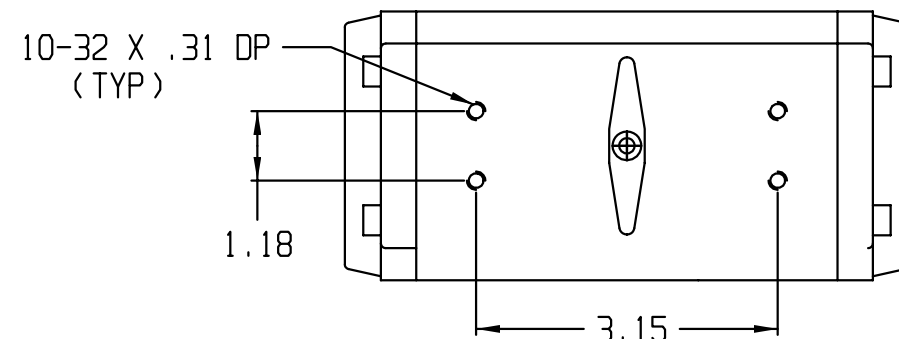

VALVE DATA	
BODY/END CAP	BRONZE, B884 C84400
STEM	316 STAINLESS STEEL
BALL	316 STAINLESS STEEL
SEATS	PTFE
THRUSTWASHER	PTFE
STEM SEAL	PTFE / VITON O-RING

UNCONTROLLED DRAWING
 THIS PRINT IS THE PROPERTY OF DYNAQUIP CONTROLS AND SHALL NOT BE COPIED, REPRODUCED, LOANED, OR DISPOSED OF DIRECTLY OR INDIRECTLY, NOR USED FOR ANY PURPOSE OTHER THAN THAT FOR WHICH IT IS SPECIFICALLY FURNISHED EXCEPT BY WRITTEN PERMISSION OF DYNAQUIP CONTROLS.

NO. VVA SERIES		FILE NO. SUB173	
TITLE BALL VALVE BRONZE - FULL PORT - NPT AP-DA ACTUATOR			
DR	DATE	CH'KD	DATE
FBA	08-03-05	LJH	08-29-05
ENGR	DATE	LJH	08-29-05



MODEL	PVA61AMS012	PVA62AMS012	PVA63AMS012	PVA64AMS023	PVA65AMS024	PVA66AMS034	PVA67AMS035	PVA68AMA064
ACTUATOR	AP10SR2	AP10SR2	AP10SR2	AP20SR3	AP20SR4	AP30SR4	AP30SR5	AP73SR4
SIZE	1/4	3/8	1/2	3/4	1	1 1/4	1 1/2	2
A	2.68	2.68	2.68	3.20	3.46	4.17	4.72	5.39
B	0.45	0.50	0.59	0.79	0.99	1.26	1.50	1.97
C	1.59	1.59	1.59	1.85	2.10	2.21	2.88	3.21
D	5.09	5.09	5.09	5.67	5.92	6.58	7.25	8.16
E	2.61	2.61	2.61	2.82	2.82	3.23	3.23	3.90
F	4.65	4.65	4.65	5.26	5.26	5.53	5.53	7.20
G	3.50	3.50	3.50	3.82	3.82	4.37	4.37	4.95
MAX. Δ PSI	300 CWP	300 CWP	300 CWP	300 CWP	300 CWP	300 CWP	300 CWP	300 CWP
WT. LBS	2.35	2.35	2.35	4.05	4.78	6.45	8.54	13.95

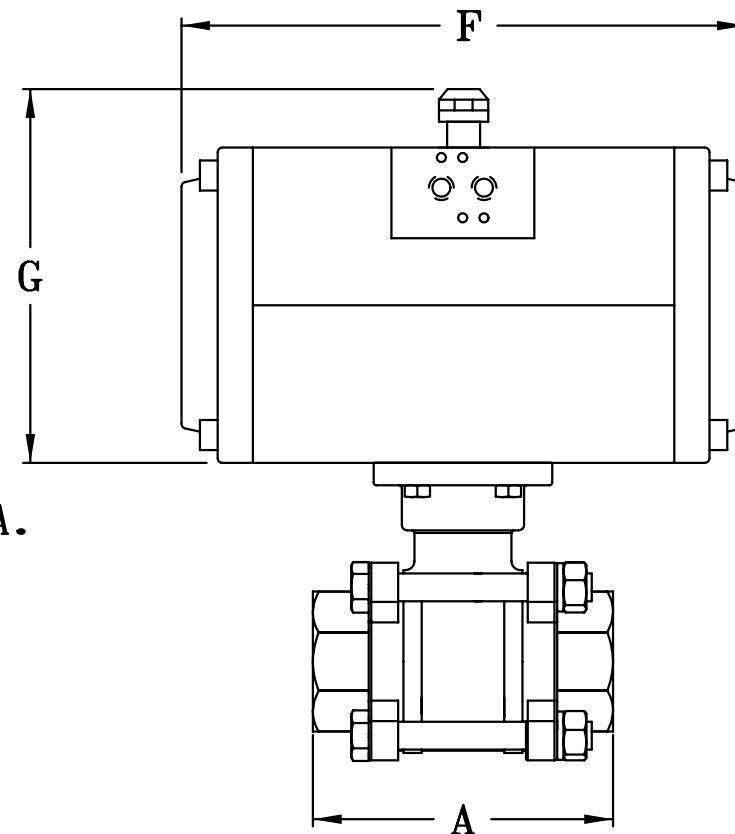
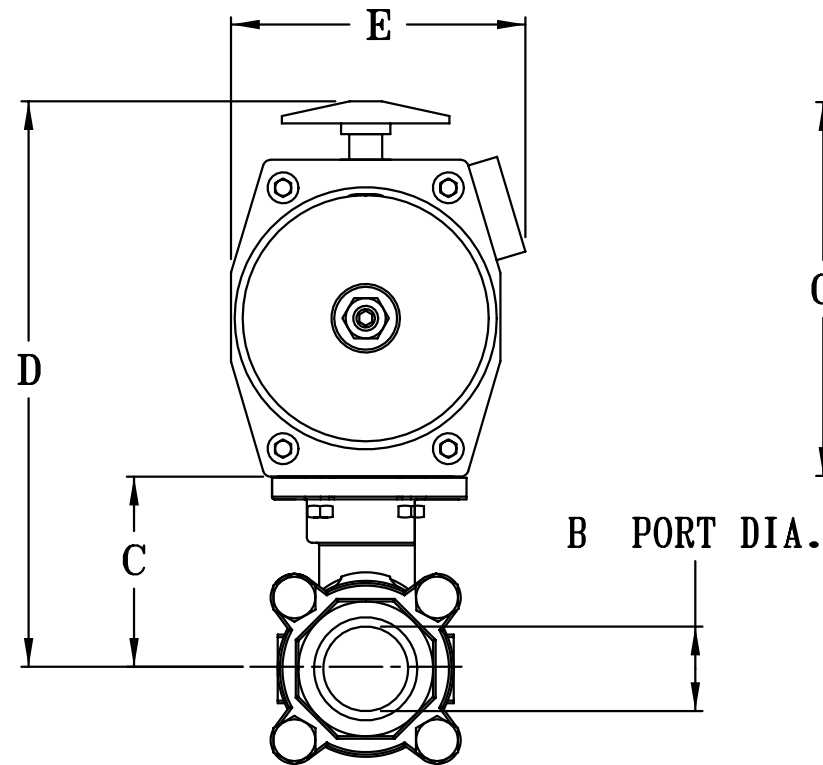
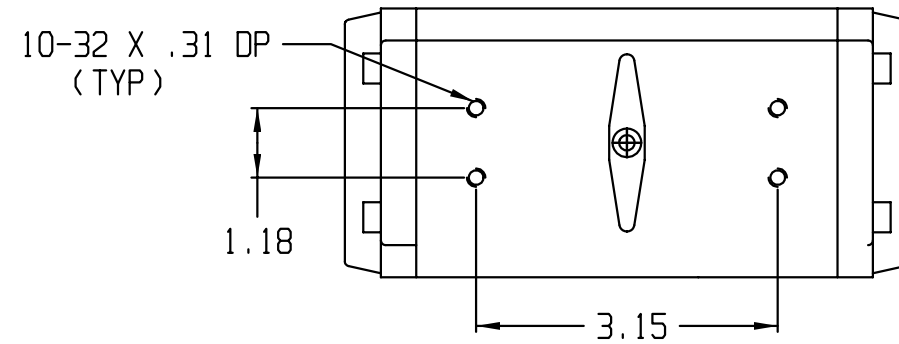

VALVE DATA	
BODY/END CAP	BRONZE, B884 C84400
STEM	316 STAINLESS STEEL
BALL	316 STAINLESS STEEL
SEATS	PTFE
THRUSTWASHER	PTFE
STEM SEAL	PTFE / VITON O-RING

**UNCONTROLLED
DRAWING**

THIS PRINT IS THE PROPERTY OF DYNAQUIP CONTROLS AND SHALL NOT BE COPIED, REPRODUCED, LOANED, OR DISPOSED OF DIRECTLY OR INDIRECTLY, NOR USED FOR ANY PURPOSE OTHER THAN THAT FOR WHICH IT IS SPECIFICALLY FURNISHED EXCEPT BY WRITTEN PERMISSION OF DYNAQUIP CONTROLS.

NO. VVA SERIES **FILE NO.**
SLB174

TITLE
BALL VALVE
BRONZE - FULL PORT - NPT
AP-SR NC ACTUATOR

DR	DATE	CH'KD	DATE	ENGR	DATE
FBA	08-03-05	LJH	08-28-05	LJH	08-28-05



MODEL	PVA61AMS012F	PVA62AMS012F	PVA63AMS012F	PVA64AMS023F	PVA65AMS024F	PVA66AMS034F	PVA67AMS034F	PVA68AMA064F
ACTUATOR	AP10SR2F	AP10SR2F	AP10SR2F	AP20SR3F	AP20SR4F	AP30SR4F	AP30SR4F	AP73SR4F
SIZE	1/4	3/8	1/2	3/4	1	1 1/4	1 1/2	2
A	2.68	2.68	2.68	3.20	3.46	4.17	4.72	5.39
B	0.44	0.50	0.59	0.79	0.98	1.26	1.50	1.97
C	1.59	1.59	1.59	1.85	2.10	2.21	2.88	3.21
D	5.09	5.09	5.09	5.67	5.92	6.58	7.25	8.16
E	2.61	2.61	2.61	2.82	2.82	3.23	3.23	3.90
F	4.65	4.65	4.65	5.26	5.26	5.53	5.53	7.20
G	3.50	3.50	3.50	3.82	3.82	4.37	4.37	4.95
MAX. Δ PSI	300 CWP	300 CWP	300 CWP	300 CWP	300 CWP	300 CWP	300 CWP	300 CWP
WT. LBS	2.35	2.35	2.35	4.05	4.78	6.45	8.54	13.95

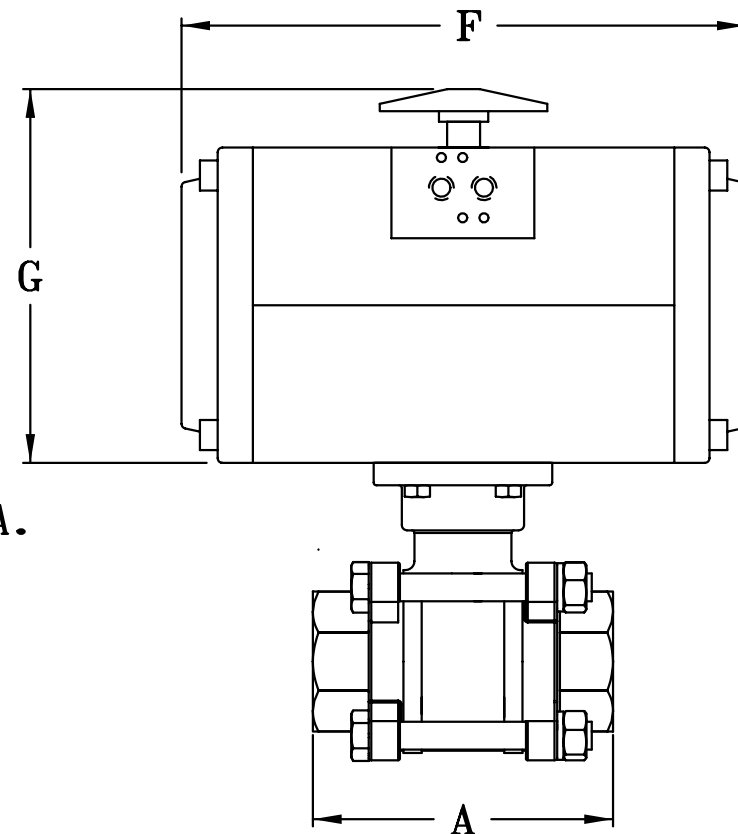
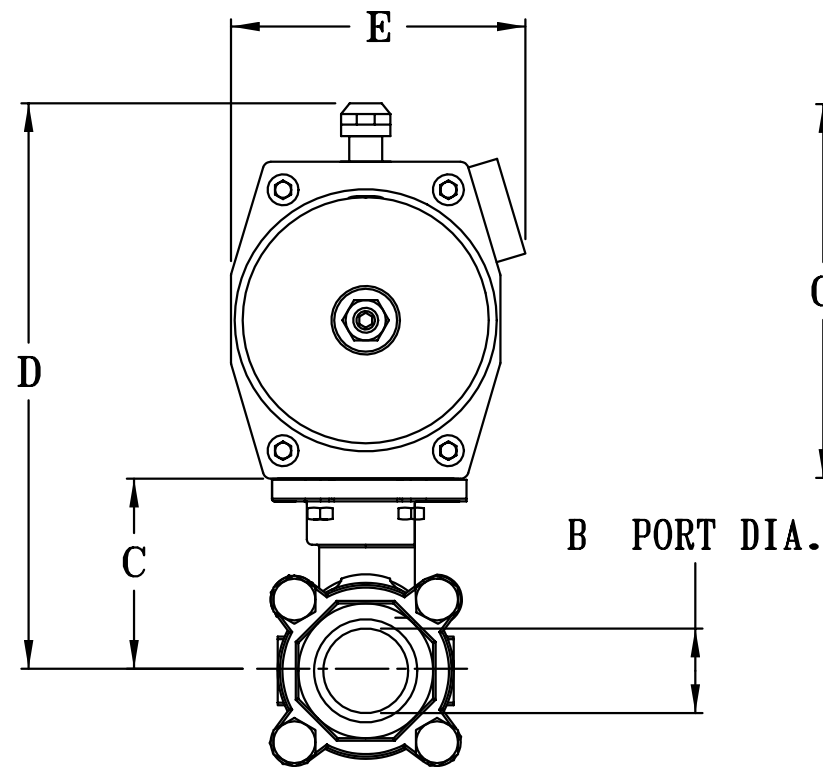
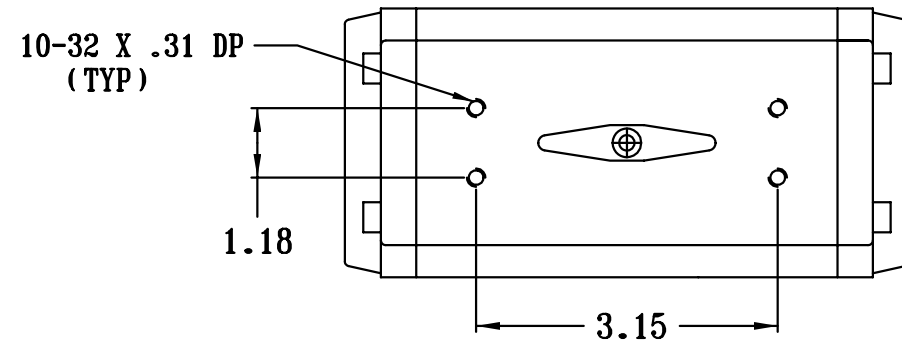

VALVE DATA	
BODY/END CAP	BRONZE, B884 C84400
STEM	316 STAINLESS STEEL
BALL	316 STAINLESS STEEL
SEATS	PTFE
THRUSTWASHER	PTFE
STEM SEAL	PTFE / VITON O-RING

**UNCONTROLLED
DRAWING**

THIS PRINT IS THE PROPERTY OF DYNAQUIP CONTROLS AND SHALL NOT BE COPIED, REPRODUCED, LOANED, OR DISPOSED OF DIRECTLY OR INDIRECTLY, NOR USED FOR ANY PURPOSE OTHER THAN THAT FOR WHICH IT IS SPECIFICALLY FURNISHED EXCEPT BY WRITTEN PERMISSION OF DYNAQUIP CONTROLS.

NO. VVA SERIES **FILE NO.**
SUB175

TITLE
BALL VALVE
BRONZE - FULL PORT - NPT
AP-SR NO ACTUATOR

DR	DATE	CH'KD	DATE	ENGR	DATE
FBA	08-03-05	LJH	08-30-05	LJH	08-30-05

