

JE Series Electric Actuators

A feature rich line designed for ease-of-use and reliability



Multi-Voltage SMART Electric Actuators

The innovative JE Series of electric actuators delivers the latest technology at an unmatched value. These actuators are multi-voltage capable with automatic voltage sensing for AC or DC power supply and can be configured for fail-safe or modulating functions as options. JE Series actuators are lightweight, compact, and quick and easy to install.

The DynaQuip Difference

For over eight decades DynaQuip has provided superior products and customer service. We offer flexible and innovative solutions for our unique customer needs. Our products are assembled, tested, and stored at our St. Clair, MO headquarters enabling us to offer quality assurance and industry best lead-times.

- Industry best lead-times
- Personal customer service
- Superior quality products
- Flexible, innovative solutions

JE Series Features

- Quarter-turn (90°) reversible operation
- Multi-voltage capability (AC/DC)
- Emergency manual override
- Isolated end-of-travel limit switches
- IP67 anti-corrosive, UV-resistant, weatherproof enclosure
- Easy wiring via external DIN plugs
- Automatic temperature control
- Anti-condensation heater
- Electronic torque limiter
- Quarter-turn (90°) reversible operation
- External LED diagnostic light
 - Multi-colored LED light provides continuous visual position indicator dome.
 - Distinctive visual position indicator dome
- Protected electrical supply
- CE Marked

JE Series Electric Actuators

Model	Max Torque (lbs) Break/Run	Voltage	Mounting	Enclosure	Duty Cycle	Speed 90°	Weight (lbs.)
AJE2S	221 / 177	24–240 VAC/24-135 VDC	F03, F04, F05	IP67	75%	10 SEC	4.0
AJE3S	359 / 309	24–240 VAC/24-135 VDC	F03, F04, F05	IP67	75%	10 SEC	4.2
AJE5S	530 / 486	24–240 VAC/24-135 VDC	F05, F07	IP67	75%	14 SEC	5.3
AJE7S	796 / 752	24–240 VAC/24-135 VDC	F05, F07	IP67	75%	30 SEC	6.6
AJE15S	1504 / 1239	24–240 VAC/24-135 VDC	F07, F10	IP67	75%	34 SEC	11.5
AJE30S	3097 / 2655	24–240 VAC/24-135 VDC	F07, F10	IP67	75%	58 SEC	11.5

Model	A	B	C	D
AJE2S	7.13"	4.34"	6.65"	2.01"
AJE3S	7.13"	4.34"	6.65"	2.01"
AJE5S	7.13"	4.34"	7.72"	2.01"
AJE7S	7.13"	4.34"	7.72"	2.01"
AJE15S	9.26"	8.43"	10.00"	4.22"
AJE30S	9.26"	8.43"	10.00"	4.22"

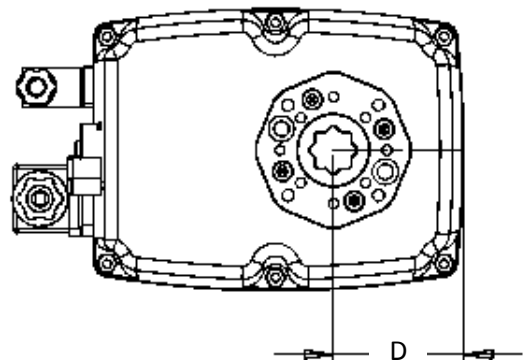
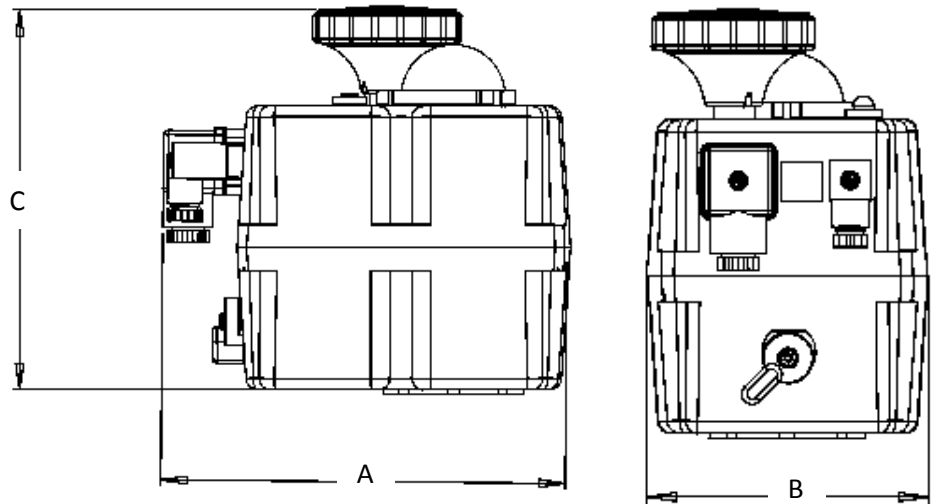

Specification Features

- Temperature: -4°F +158°F
- Housing: Polyamide
- Output Shaft: Stainless Steel
- Fasteners: Stainless Steel
- Manual Override: Declutching
- Compartment Heater: Standard
- End of Travel Signal: Dry Contact



Just Ask DynaQuip: 800-545-3636 | info@dynaquip.com | dynaquip.com